

CBX Flexible Acoustic Barrier for ceilings

Flexible composite quilt to reduce sound transmission in ceiling voids

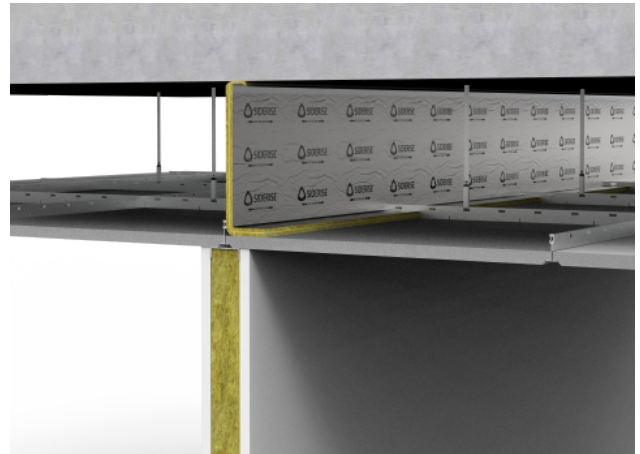

Application

Siderise CBX flexible acoustic barriers for suspended ceilings are flexible composite quilts designed for free- hanging in ceiling voids above partition lines. They have been specifically developed to to reduce `room to room' sound transmission via a common ceiling void.

Being flexible and thin the quilts are ideal for remedial treatment requiring only limited disruption to an existing suspended ceiling during installation.

As Siderise CBX are faced on both sides and the joints are normally taped, to reduce fibre migration .For critical applications the product can be made fully enclosed by pre-wrapping all edges with Siderise foil tape before final installation.

Product Description

Siderise CBX is a multi-layered composite material. The central layer is a thin, flexible bitumen free polymeric barrier mat. The barrier incorporates a laminated 'anti-creep' layer. This is designed to prevent possible long-term elongation of the product in its normal free hanging condition. It additionally provides reinforcement to through penetrations at fixing points.

To each side of the mass barrier is a glass fibre insulation layer. This is faced as standard on the exposed surface with a reinforced aluminium foil.

Handling

Siderise CBX are fairly heavy barriers but very flexible and care should be taken when handling to protect the product from damage and the handler from personal injury.

Weight per sheet (2000mm x 1200mm std)= 26kg per sheet

Before lifting each sheet should be rolled or folded down the length of the sheet to create a package approximately 1200mm long x 300 - 500mm width/diameter. The product can then be lifted. All standard health and safety lifting/handling techniques should be observed.

Fire Performance

In terms of 'Reaction to Fire', the products are classified to EN 13501-1. See Table 1.

Table 1: Reaction to Fire Performance

Product Ref.	Classification
CB10P	B-s1,d0

Acoustic Performance

The product's acoustic performance is tested in accordance with BS EN ISO 10140-2:2021. Weighted sound reduction index (dB Rw) values for various grades of the product are given below in Table 2.

Table 2: Acoustic performance - Weighted Sound Reduction Index

Product Ref.	Thickness (mm)	Product Surface Weight (kg/m ²)	Rw (dB)	C:Ctr
CB10P	40	11	35	(-1;-5)
CVB/80/P10/100 + 50mm cavity + CB10P	195	29	46	(-2;-7)
CB10P + 50mm cavity + CVB/80/P10/100	195	29	44	(-1;-7)
CB10P + 50mm cavity + CVB/75/LAM/120	210	20	46	(-4;-11)
CB10P + 50mm cavity + CB10P	130	22	49	(-5;-12)

Technical Specification

Table 3: CBX Product Properties

Properties	Value
Form supplied	Sheets 2000mm x 1200mm
Colour	Silver
Finish	Bright aluminium Foil
Thickness	40mm (Barrier can be readily compressed)
Surface weight	11kg/m ²
Density	Nominal 275kg/m ³
Cavities	up to 1800mm
Resistance to fire	None – Acoustic only barrier
Reaction to fire	Class B-s2,d0 to EN 13501-1:2019 - see Table 1

Additional Information Available

Products available

The following Siderise Building Acoustics products are available:

- Siderise ALS acoustic lining slab
- Siderise AVC acoustic void closures for tops of walls
- Siderise BM/P10 series barrier mat
- Siderise CBX flexible acoustic barriers
- Siderise CVB/LAM acoustic barriers for suspended ceilings
- Siderise CVB/P10 acoustic barriers for suspended ceilings and raised access floors
- Siderise FIP façade interface panel
- Siderise FLX foam based flexible acoustic barriers
- Siderise MC mullion cover
- Siderise MI Mullion/Transom Inserts
- Siderise RF Cavity Barrier and Firestop for Raised Access Floors

Contact us for a copy of our building acoustics range brochure.

Contact us for further information on our CPDs

Technical Support

Technical & Sales support

For further information and advice, please contact:

Technical support: Technical Team, +44(0)1473 827695, technical.sspl@siderise.com

Sales support: Internal Sales Team, +44(0)1473 827695, sales.sspl@siderise.com

Context

The information in this datasheet is believed to be accurate at the date of publication. Siderise has a policy of continuous product improvement and reserves the right to alter or amend the specifications of products without prior notice. Siderise does not accept responsibility for the consequences of using the products described outside of the recommendations within this datasheet. Expert advice should be sought where there is any doubt about the correct specification or installation of Siderise products.

CBX_7_03_20260129_1340