

Siderise ALS acoustic lining slab

A black glass tissue faced stone wool slab used for acoustic treatment on walls and ceilings/soffits.

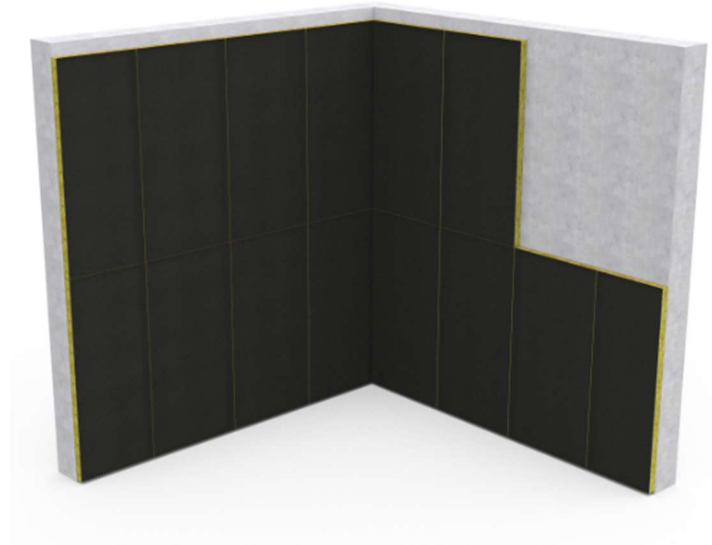

Fixing guidance for Siderise ALS acoustic lining slab using PP1 or IH3

These fixing guidance notes are for fixing Siderise ALS in the vertical plane, i.e. to walls. For fixing in the horizontal plane, i.e. soffits and ceilings, we recommend that metal hangers are mechanically fixed to the soffit or ceiling. The type of mechanical fixing needs to be determined by the design/installation team to suit the substrate material.

1. Before using

Test the product to determine its suitability for each specific application. Please note we have no control over the method of application, environment or parent surface bonding conditions, therefore, the user assumes all responsibility, risk and liability in connection with the use and application of this product.

2. Clean Parent Surface

All hangers must be applied to a clean, dry, uncoated surface that is completely free of contaminants such as dirt, dust, film, grease, oil, paint or other protective coatings, rust salt etc. Concrete should be wire brushed to remove all laitance.

3. Apply Adhesive to the Hanger

Prepare only one hanger at a time. Apply a daub of adhesive (about the size of a walnut) on the perforated base plate with a putty knife or cartridge gun. For best results with hangers, use Siderise AD-PIN premium brand adhesive in 300ml cartridges. We cannot consider any claim of product failure resulting from the application of hangers with other brands of adhesive.

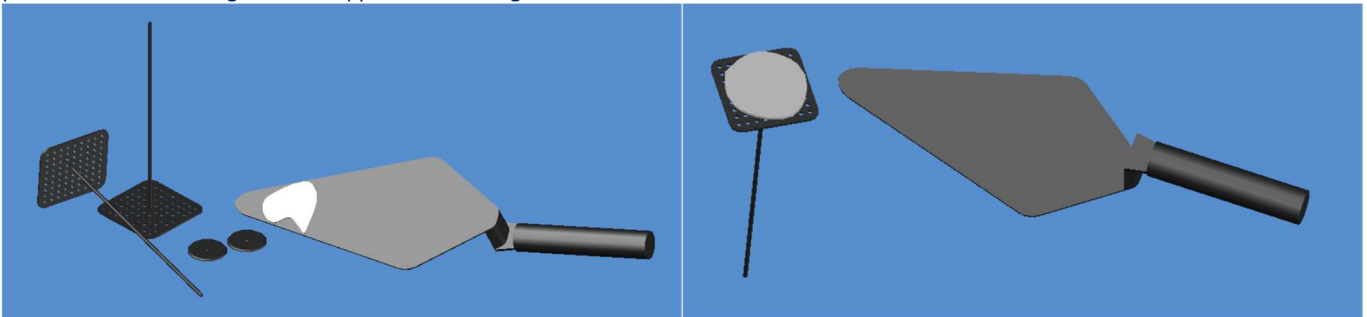

4. Select Hanger Locations

Press hanger firmly into place with a twisting motion to assume an even spread of adhesive. Properly installed, the adhesive should be between 1mm to 2mm thick and should protrude through the perforations and beyond the edges of the base plate.

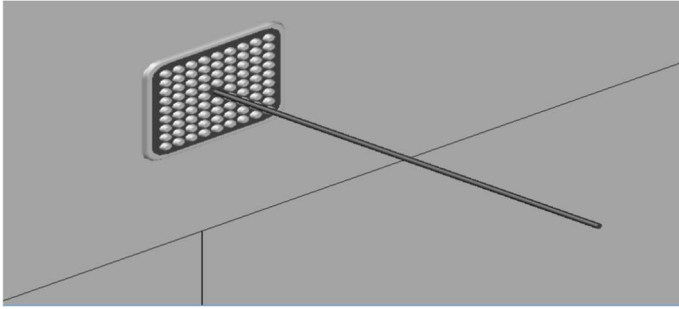

Do not install when ambient temperature is below 4.5°C or higher than 35°C. Best results are generally obtained when ambient temperature is between 15°C and 29°C. For application temperatures outside these ranges please consult a specialist adhesive supplier.

Hanger spacing should not exceed 600mm on centre, see table 1 below for guidance on the number of fixings required.. Under high temperature / high humidity conditions, remove the hanger from parent surface for a few seconds after initial application to allow adhesive to be exposed to air. Then reapply with the same twisting motion.

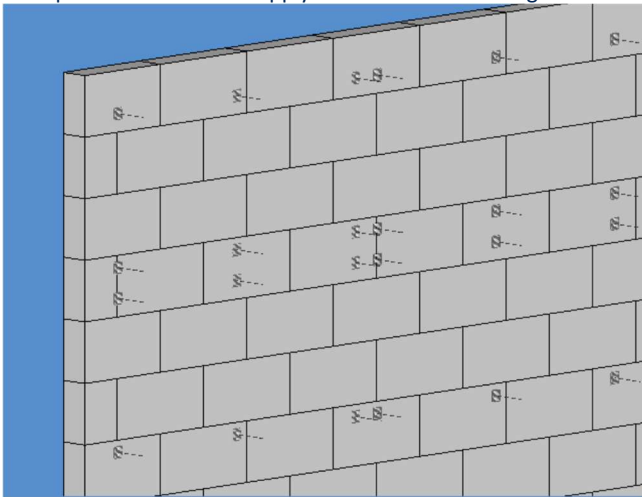

Depending on the size and thickness of Siderise ALS acoustic lining slab used, and the orientation, the number of fixings required will alter. The information in Table 1 is offered as guidance only.

Table 1 – Sizes and fixing requirements

Product	Orientation	Number of hangers required
ALS 25-75mm	Vertical (Wall)	9 (PP1 or IH3)
ALS 100mm	Vertical (Wall)	12 (IH3)
ALS 25-100mm	Horizontal (Ceilings)	12 (IH3)

5. Allow Adhesive to cure thoroughly

Allow adhesive to cure thoroughly before installing insulation, (minimum time 24-48 hrs), drying times vary, therefore, user should ventilate the application area to remove entrapped adhesive solvent vapours and to shorten the drying time.

High humidity conditions or ambient temperature under 7.2°C may require additional curing time. Before installing insulation make certain that the curing process is complete and that the hangers will develop full strength.

6. Offer up and Impale ALS System

When considering the order of application of the ALS System, the following shows a typical order of treatment.

Treatment would be started to the top left of the treatment area, with all sheets orientated to suit the proposed layout. The first sheet should be offered up to the hangers, then impaled on to the Insulation Hanger spikes, the second sheet should be positioned directly below, tightly abutting the first sheet, this should be repeated until the bottom of the treatment area, completing the 1st row.

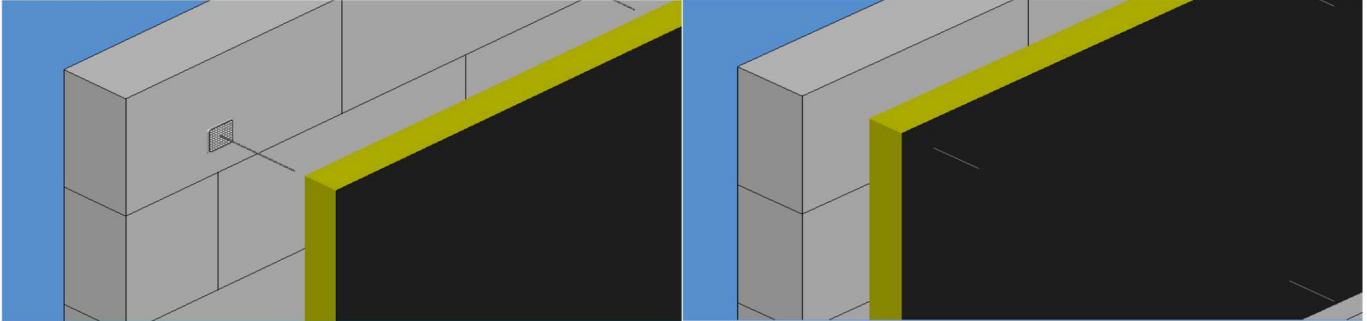

The second row would again start at the top of the treatment area, to the right of the 1st sheet, this should be continued as above, further rows would be fitted until complete treatment area is covered.

7. Secure with self-locking washers

After installing insulation, slide on self-locking washer (Dome side out) to pin without compressing insulation. Trim off surplus pin if necessary. Hanger loading should not exceed 3lbs (1.36 kg) per hanger.

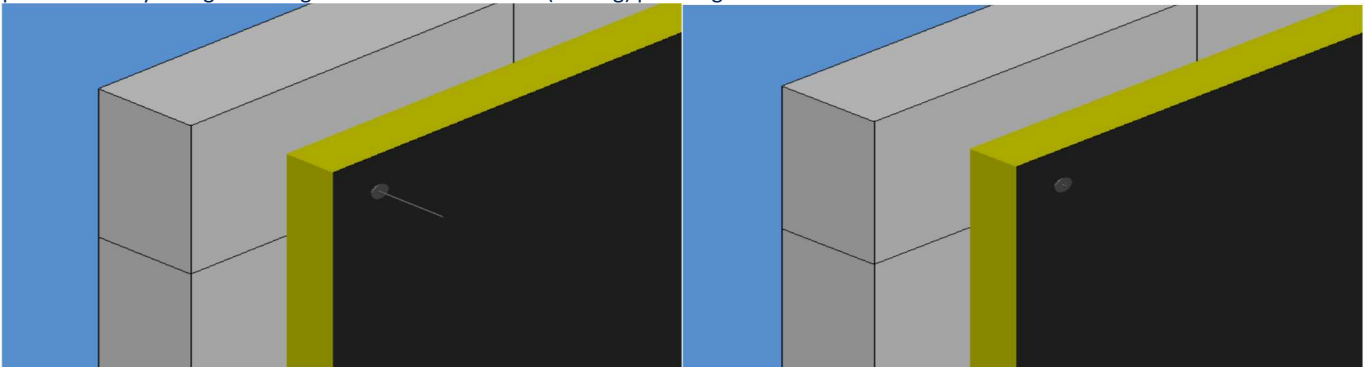

For any queries relating to these guidelines, including any 'Project Specific' queries, please contact our Technical Team.

Products available

The following Siderise products for use in the Building Acoustics Sector are available:

- Siderise ALS acoustic lining slab
- Siderise AVC acoustic void closures for tops of walls
- Siderise BM/P series barrier mat
- Siderise CBX flexible acoustic barriers
- Siderise CVB/LAM acoustic void barriers for suspended ceilings
- Siderise CVB/P10 acoustic void barriers for suspended ceilings & raised access floors
- Siderise DWX duct acoustic barriers
- Siderise FIP façade interface panel
- Siderise FLX flexible acoustic barrier for suspended ceilings
- Siderise MC mullion cover system
- Siderise RF Cavity Barrier and Firestop for Raised Access Floors

Contact us for a copy of our building acoustics range brochure.

Contact us for further information on our CPDs

Further information

Technical support

For further information please contact our technical team at the address below.

Sales & Technical

Sales support

Internal Sales Team

+44(0)1473 827695

sales.sspl@siderise.com

Technical support

Technical Team

+44(0)1473 827695

technical.sspl@siderise.com

Siderise (Special Products) Limited

Lady Lane Industrial Estate, Hadleigh, Suffolk IP7 6BQ United Kingdom

The information published herein is given in good faith and is believed to be accurate at the time of publication. Please check that this version is current. Siderise has a policy of continuous product improvement and reserves the right to alter or amend the specifications of products without prior notice. Siderise does not accept responsibility or the consequences of using the products and systems described outside of any given recommendations within this document or its other official documentation. Recommendations for use should be verified in regard to the suitability and compliance with actual requirements, specifications and any applicable laws, codes, and regulations. Expert advice should be sought where there is any doubt about the correct specification or installation of Siderise products and systems.