

Fire & Acoustic Party Wall Closer

Comprises a strip of semi-rigid mineral wool insulation bonded to a black polyethylene dpc.

FAC is supplied in standard 1200mm unit lengths and can be readily cut as required.

Reduces flanking sound transmission at the junction of compartment and external walls.

Meets requirements of Approved Document E (2003 edition) of the Building Regulations.

Robust product and practical solution.

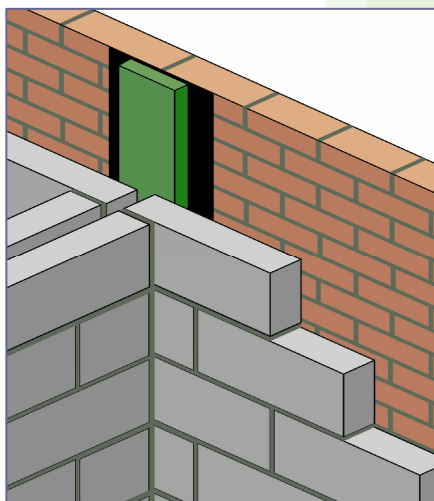

Acoustic performance

At junctions where a separating wall meets the external cavity wall, Approved Document Part E of the Building Regulations requires the use of a mineral wool closer, which is protected by a suitable dpc, to minimise flanking sound. FAC satisfies this requirement.

Fire performance

Installation of standard thickness FAC is suitable for a one hour fire rating. The product must be installed under tight compression across the cavity with all joints being tightly abutted. Verification of fire performance is available upon request.

Thermal performance

Thermal conductivity: $\lambda = 0.035\text{W/m.K}$

Installation

Install as brickwork / blockwork proceeds with the dpc against the outer leaf and ensure tight abutment of insulation between adjacent units.

When installing multiple units, the upper pieces must be installed with the 100 mm dpc extension at the bottom. This must overlap the outside face of the dpc on the lower APW unit.

The dpc flanges extend either side of the insulation by 40mm.

Installation must follow good practice for the detailing of damp proof courses, as set out in the relevant clauses of BS 5628: Part 3, BS 8215 and BS 8000: Part 3.

Health and safety

Current HSE 'CHIP' Regulations and EU directive 97/69/EC confirm the safety of rockwool mineral wool. The fibres are not classified as a possible human carcinogen. A Material Safety Data Sheet is available upon request.

Dimensions

Insulation length: 1200mm
 Insulation width: 260mm
 Standard insulation thicknesses: 50, 65, 75 & 100mm
 Dpc length: 1300mm
 Dpc side laps: 40mm
 Dpc bottom lap: 100 mm

Other thicknesses to suit different cavity widths are available upon request.

The Dpc is black polyethylene to BS 6515.

Technical Advice

For further information please contact us at the address below.